



WeatherAll® XL



WeatherAll® XL offers professional quality materials for professional results. High performance polystyrene insulation bonded to proven weather-resistant facers provides long term durability and delivers value throughout the years.

WeatherAll® XL - Blending Performance and Value

WeatherAll® XL provides improved thermal power, keeping your home cooler in the summer and warmer during cold months. Balancing performance and economy, it delivers year round benefits for as long as you own your home.



Continuous Insulation (CI) is recognized by the International Code Council as an important thermal barrier for your home's exterior. WeatherAll® XL forms a rigid CI layer that offers permanent energy savings by improving the thermal performance of your home.

Better Fit, Enhanced Beauty

WeatherAll® XL is designed to provide a solid smooth foundation for the siding you've chosen for your home. Enhancing the finish to enhance the beauty of your home.

Improved Thermal Performance

Save year round. Sealing leaks cuts down on air infiltration and resulting energy loss. Plus a rigid CI layer works hard in places unprotected by fiberglass, places like studs and framing members.

WeatherAll® XL, the plus in *CI Plus*™.





WeatherAll® XL



WeatherAll® is the newest member of our family of underlayment products that began with Insul-Perm in 1978. WeatherAll® offers high-quality performance in a high-value package. WeatherAll® incorporates features designed to meet industry best practices for the best performance under residential cladding. WeatherAll® is designed for the professional installer to provide long-lasting benefits to the homeowner.



WeatherAll® XL - Blending Performance and Value

WeatherAll® Breathes

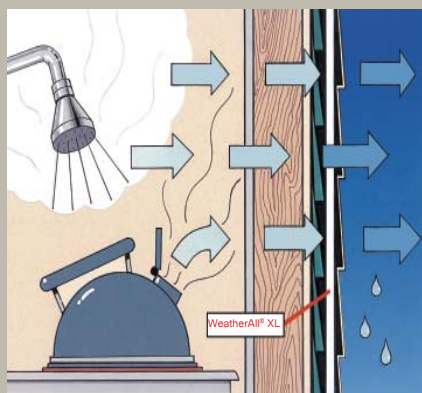

We put over 1,000 vapor holes* in every square foot of WeatherAll®. These tiny holes enhance water vapor permeability. This important feature helps ensure that water vapor can escape the wall cavity. Trapped water vapor can cause mold formation and, if unnoticed, can lead to structural damage.

*Also available without perforations.

Corrects Wall Design Deficiency

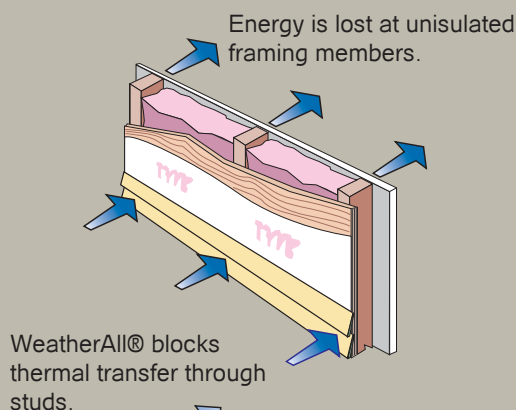

WeatherAll® blocks thermal transfer through studs.

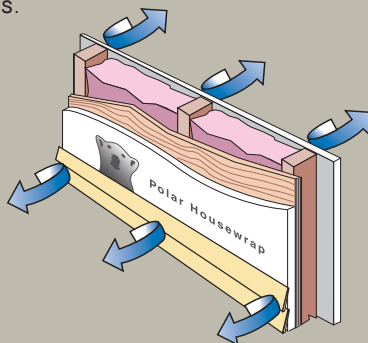

CI Plus™ R-Values

	Thermal Power		System
Thickness	75°F	25°F	75°F*
1/4"	.96	1.1	3.0
3/8"	1.4	1.6	3.4
1/2"	2.0	2.2	4.0
3/4"	2.9	3.3	4.9
1"	3.9	4.2	5.8

* To achieve System R the reflective film must be adjacent to an average 3/8" air space.



32 Gramar Avenue • Prospect, CT 06712
800•237•3763
www.polarcentral.com

The WeatherAll® family of insulation products are sold exclusively through distributors serving professional contractors.

WeatherAll®, helping turn carbon footprints into thumbprints™

Caution:

All foam plastic insulation will ignite if exposed to fire of sufficient heat and intensity. This product should not be exposed to open flame or other ignition sources. Install in compliance with applicable building codes.

©2014 Polar Industries